

Ansichten, Grundrisse und Schnitte

Moschee Venloer Straße / Innere Kanalstraße, Planung Stand Januar 2008

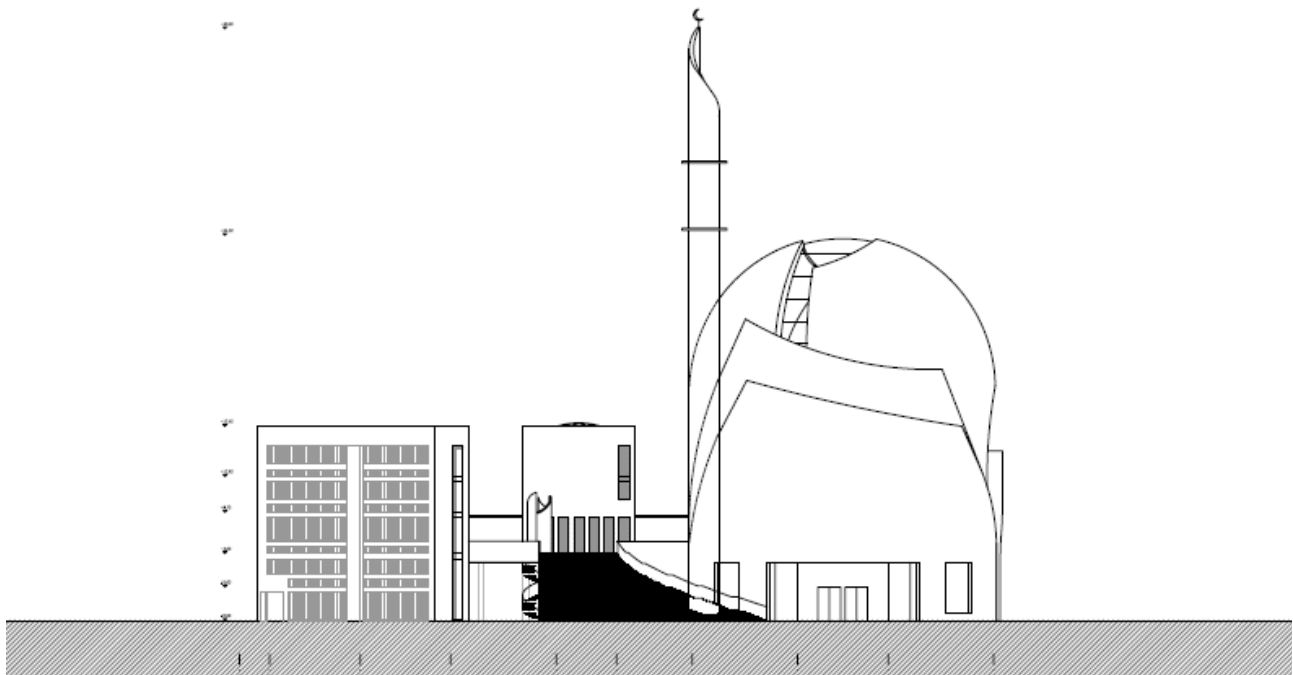

Ansicht Venloer Straße

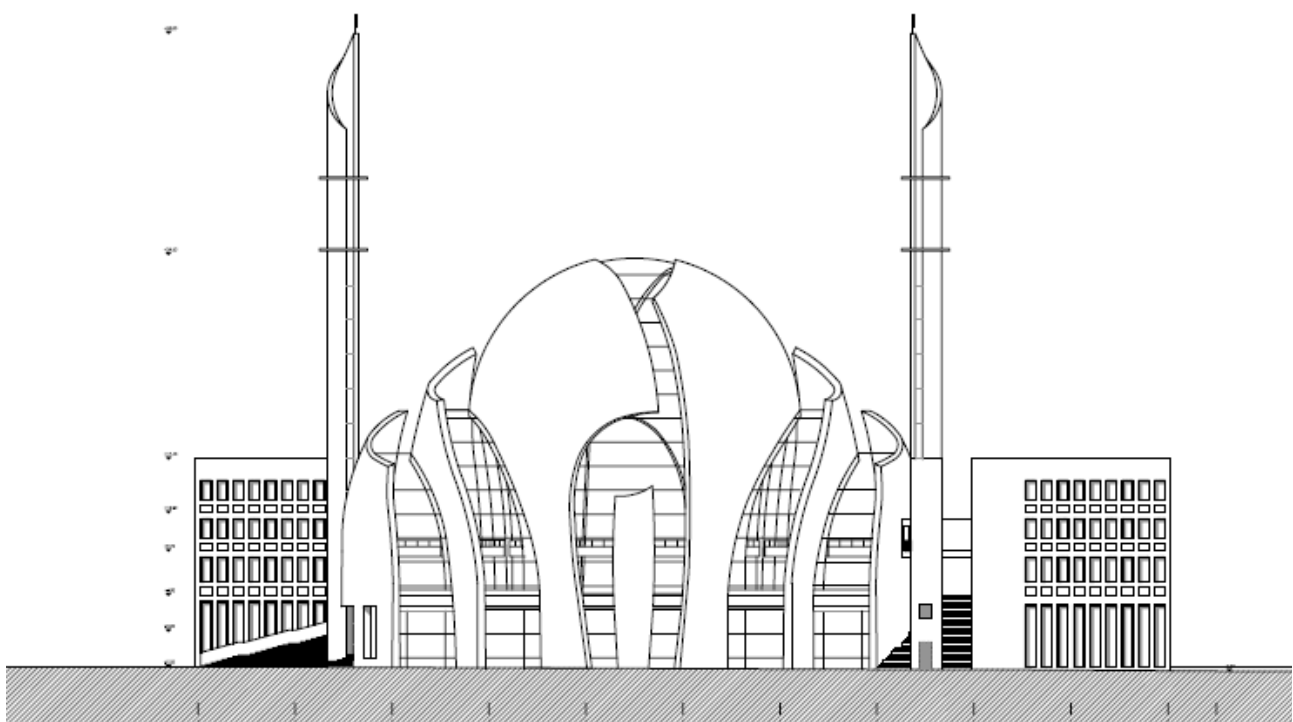

Ansicht Innere Kanalstraße

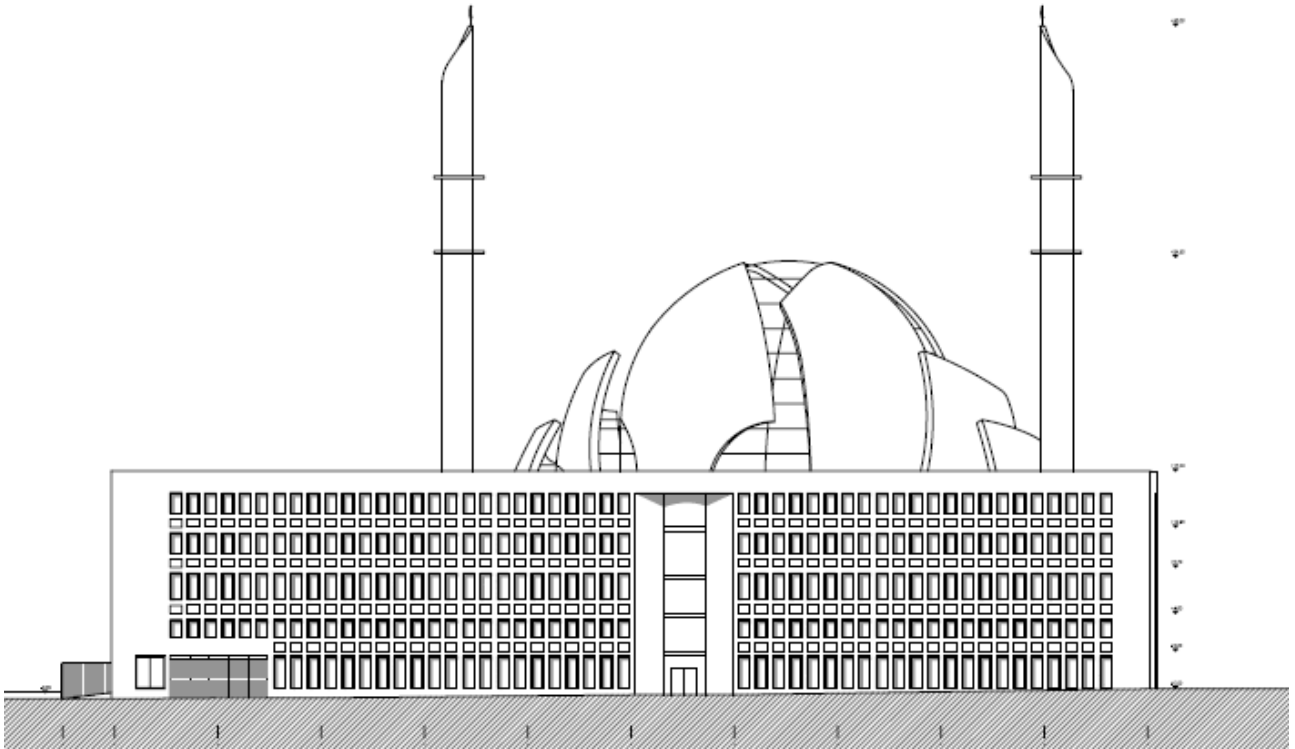

Ansicht Fuchsstraße

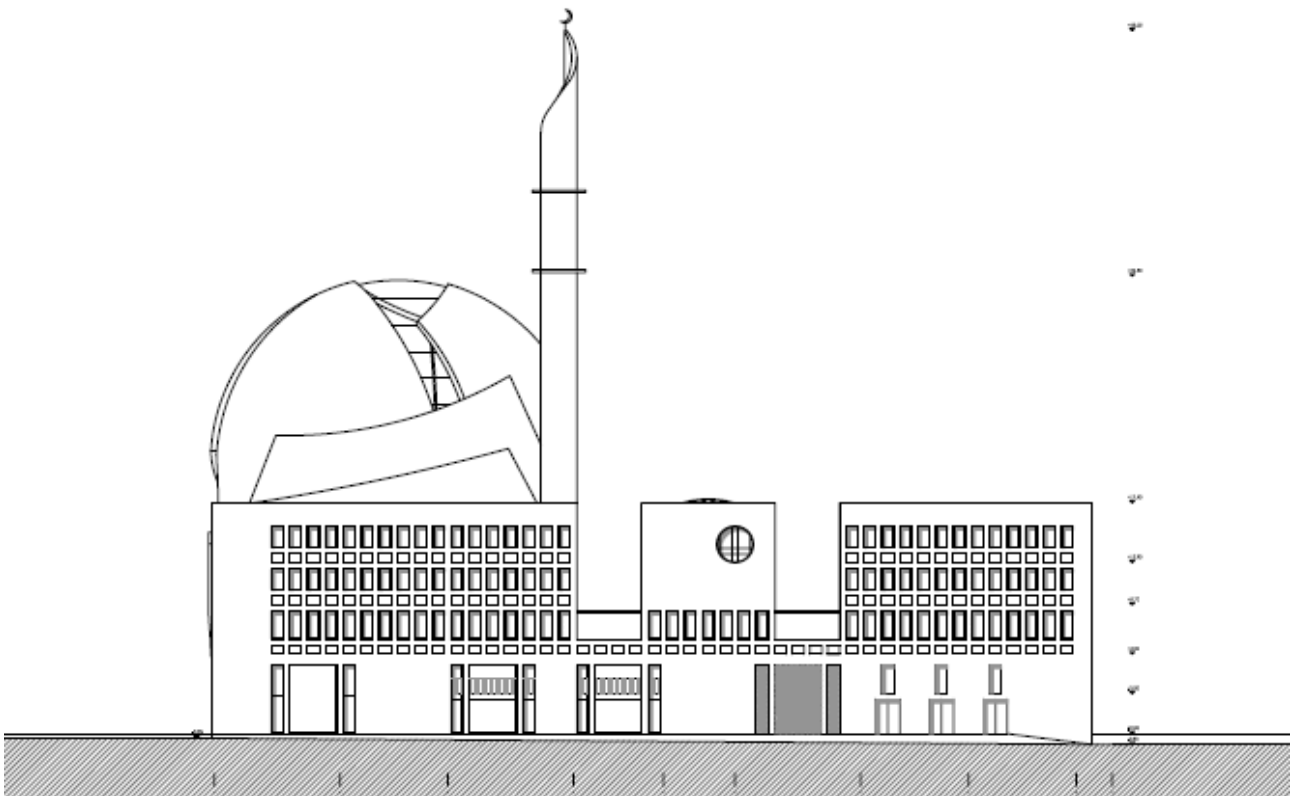

Ansicht Sportanlage

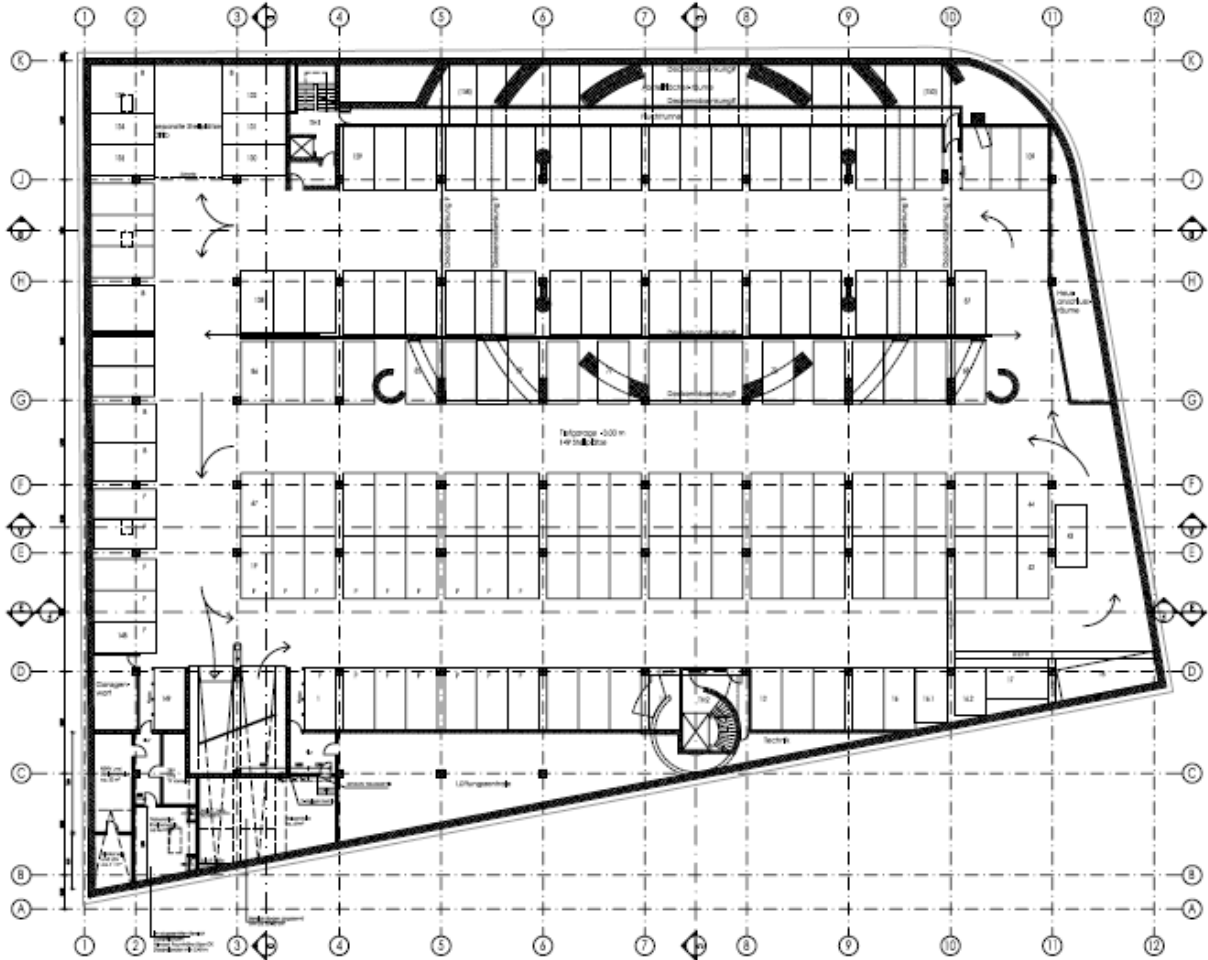

Grundriss Tiefgarage

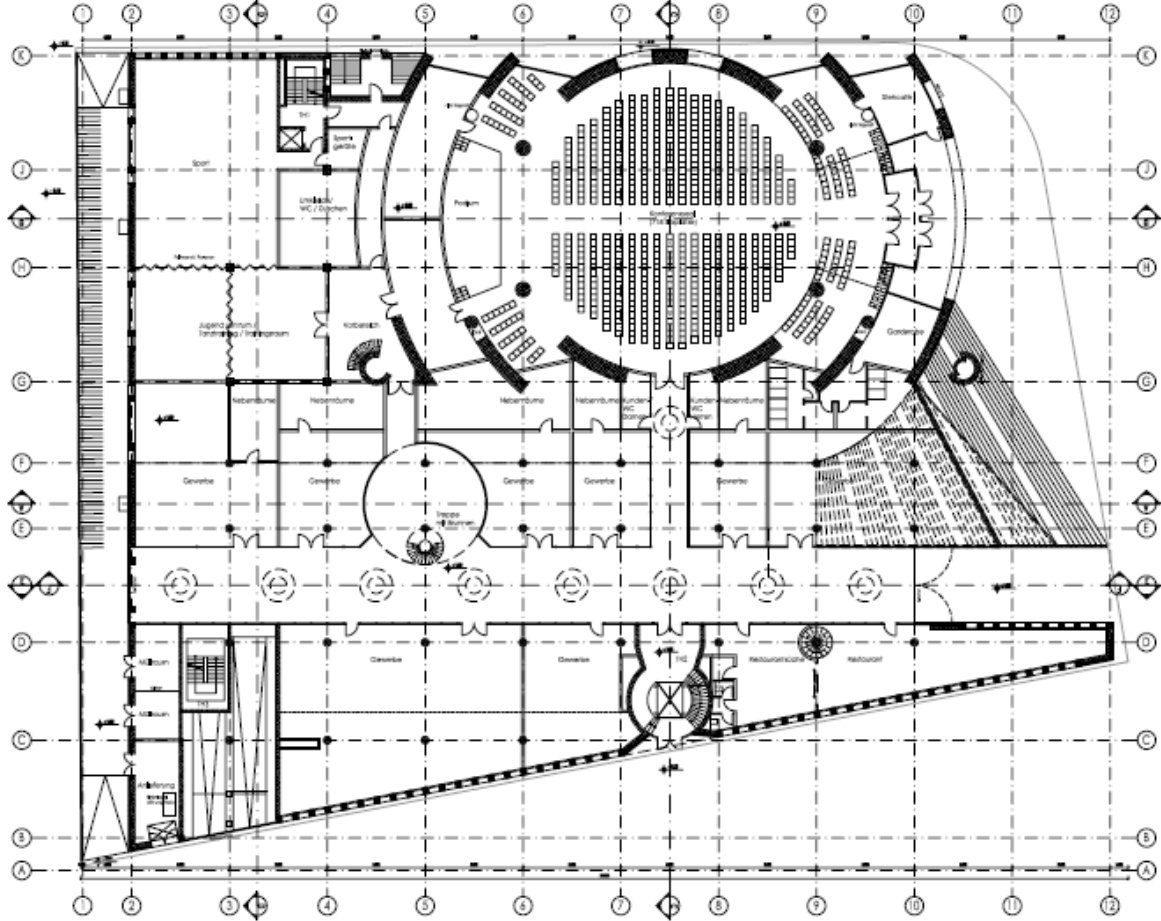

Grundriss Erdgeschoss

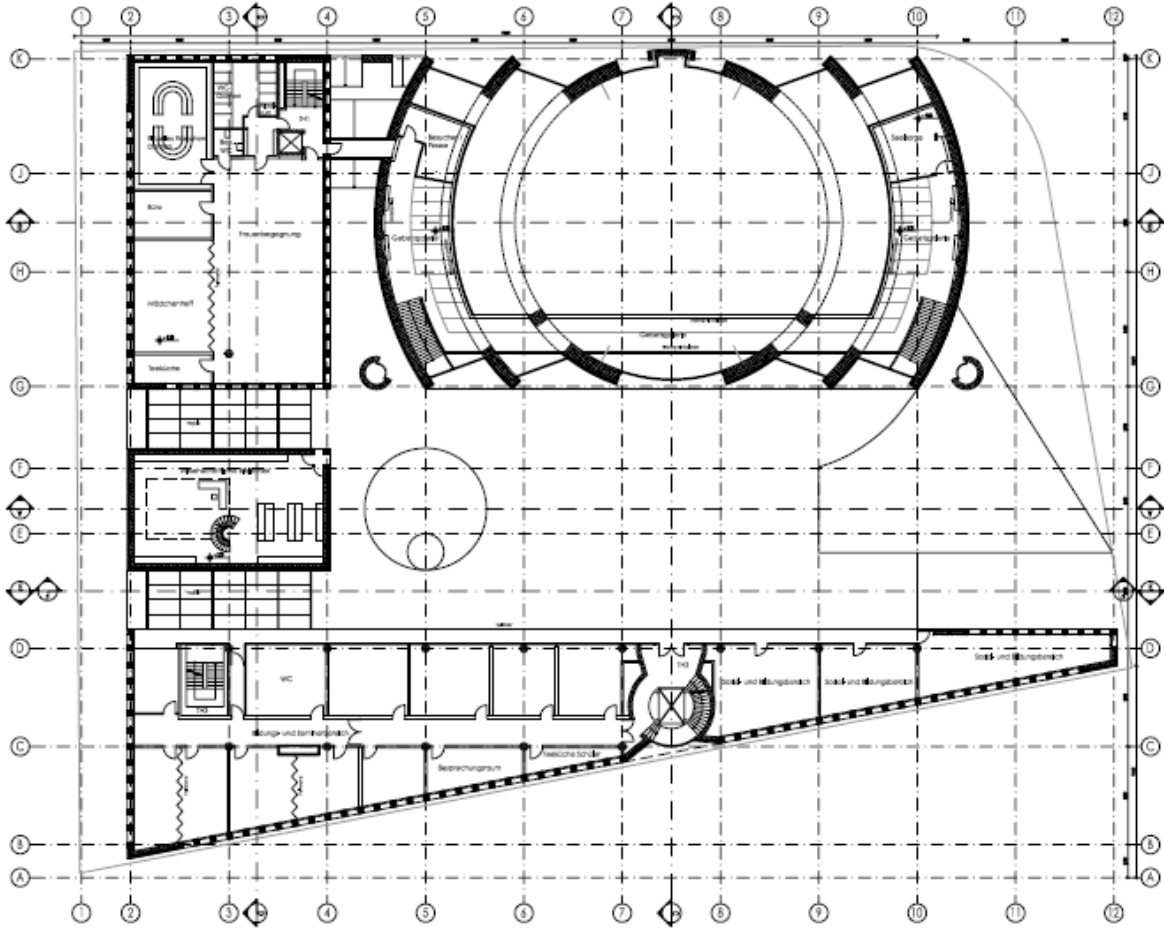

Grundriss 2. Obergeschoss

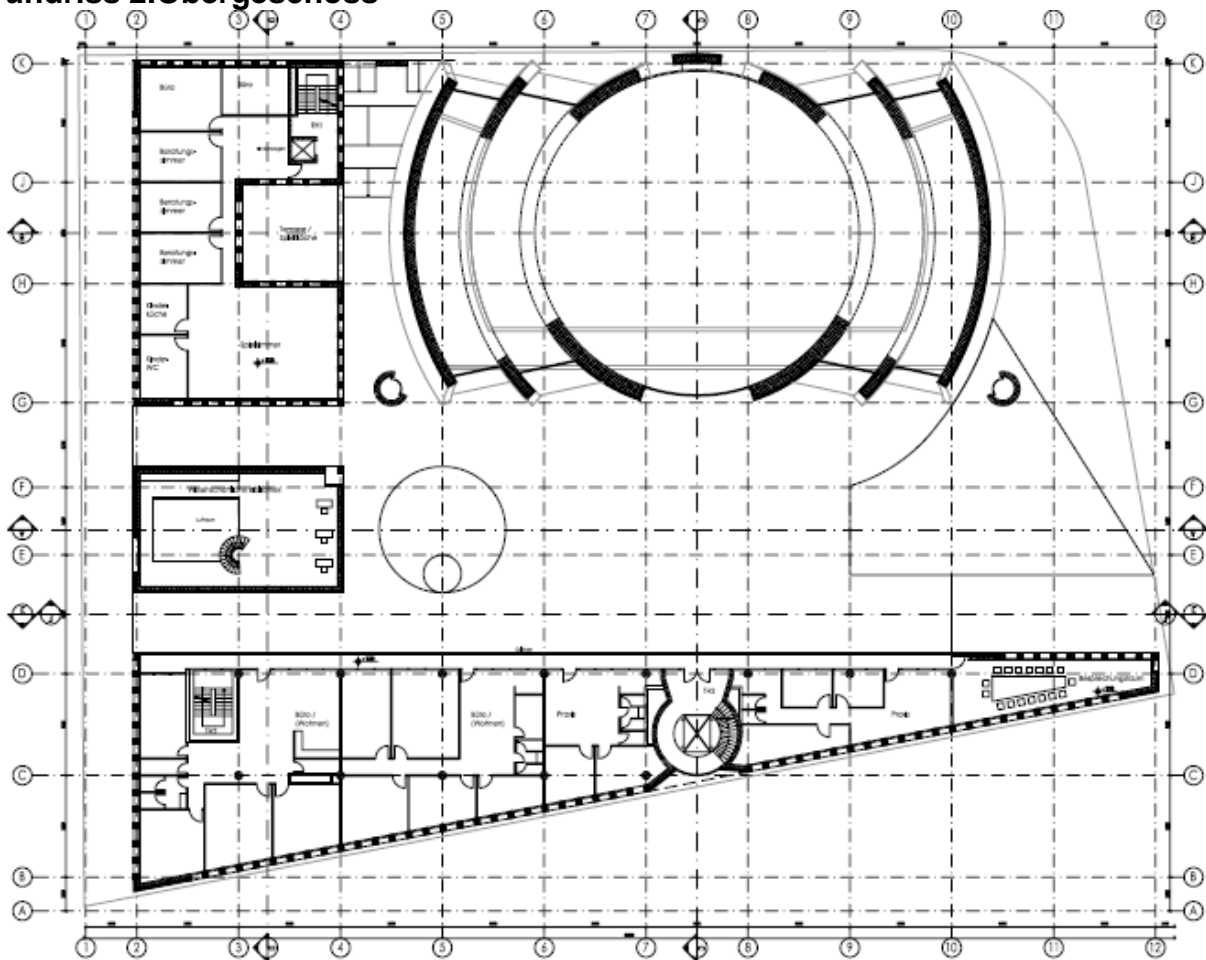

Grundriss 3. Obergeschoss

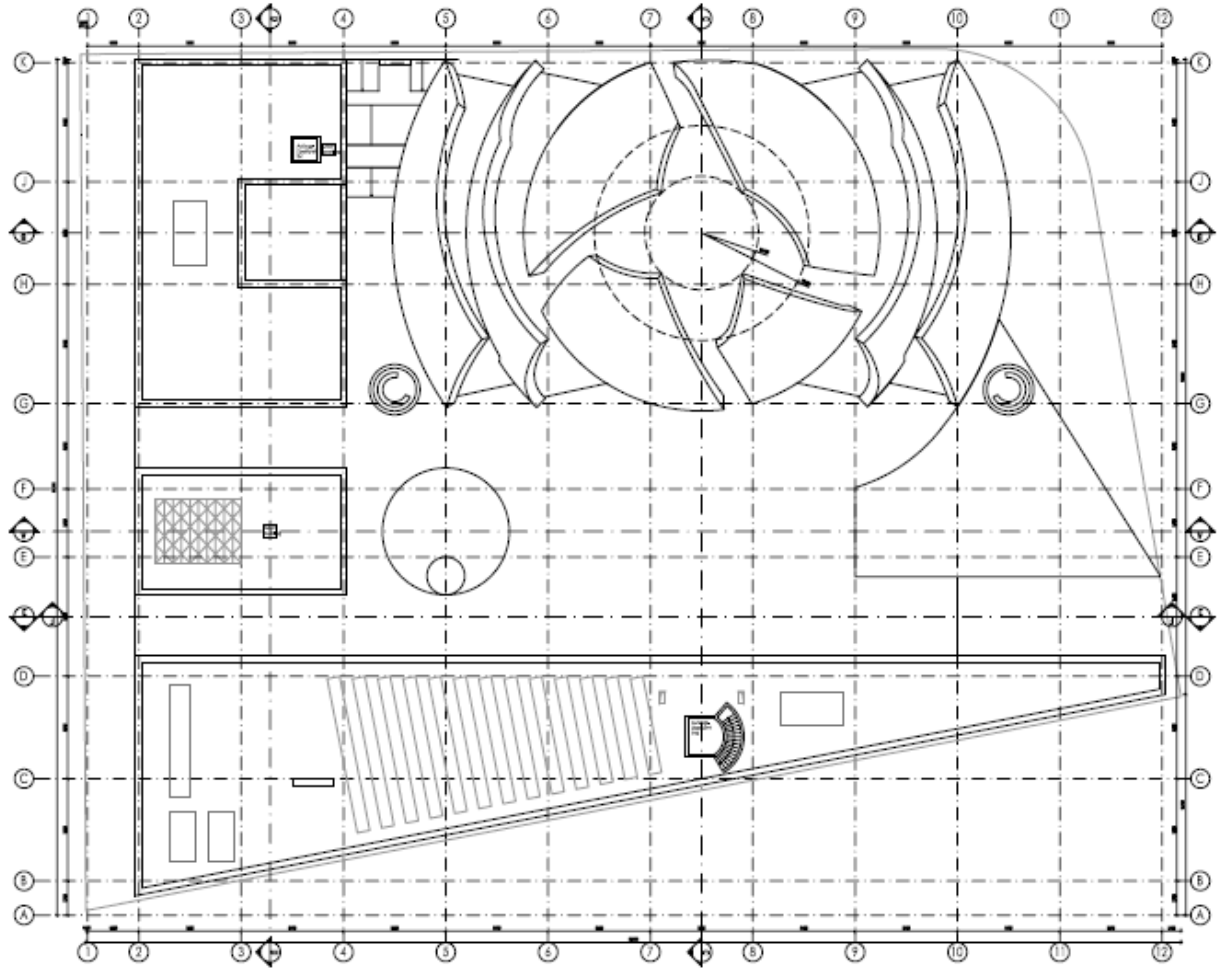

Dachaufsicht

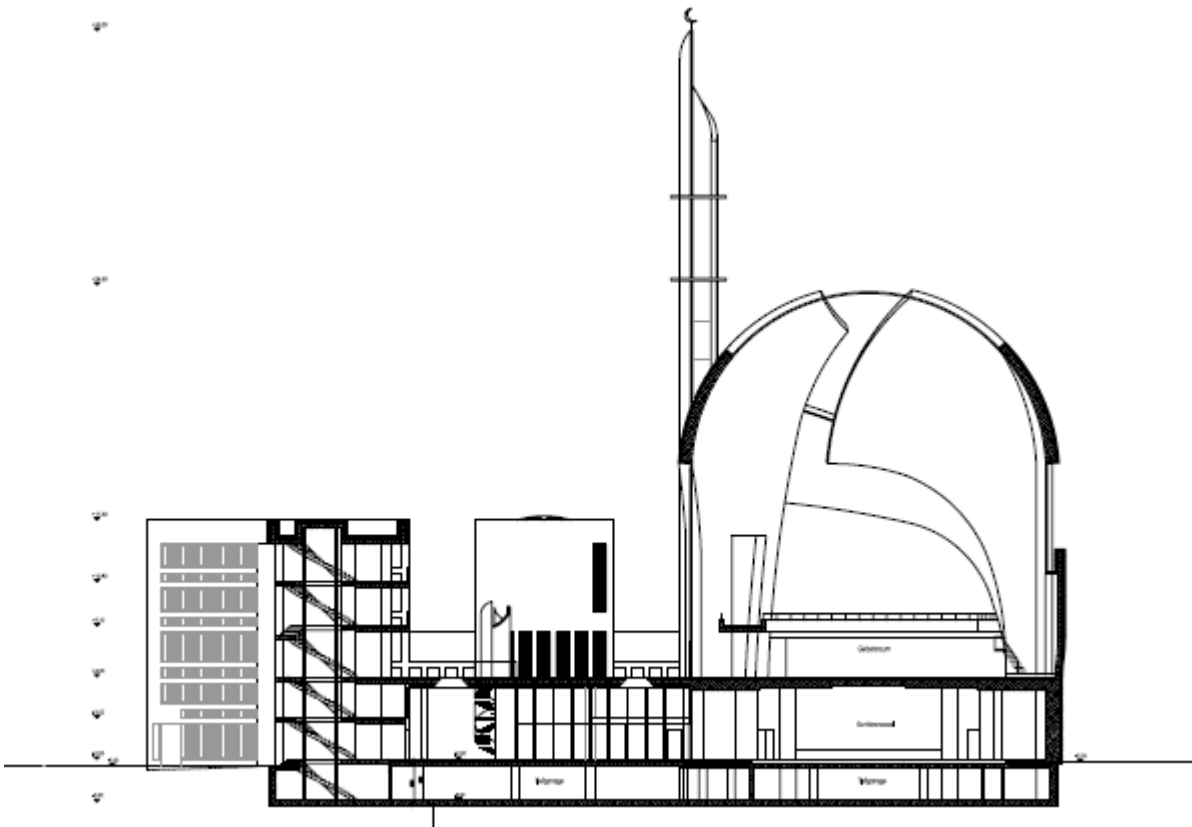

Schnitt Fuchsstraße / Innere Kanalstraße (Moschee)

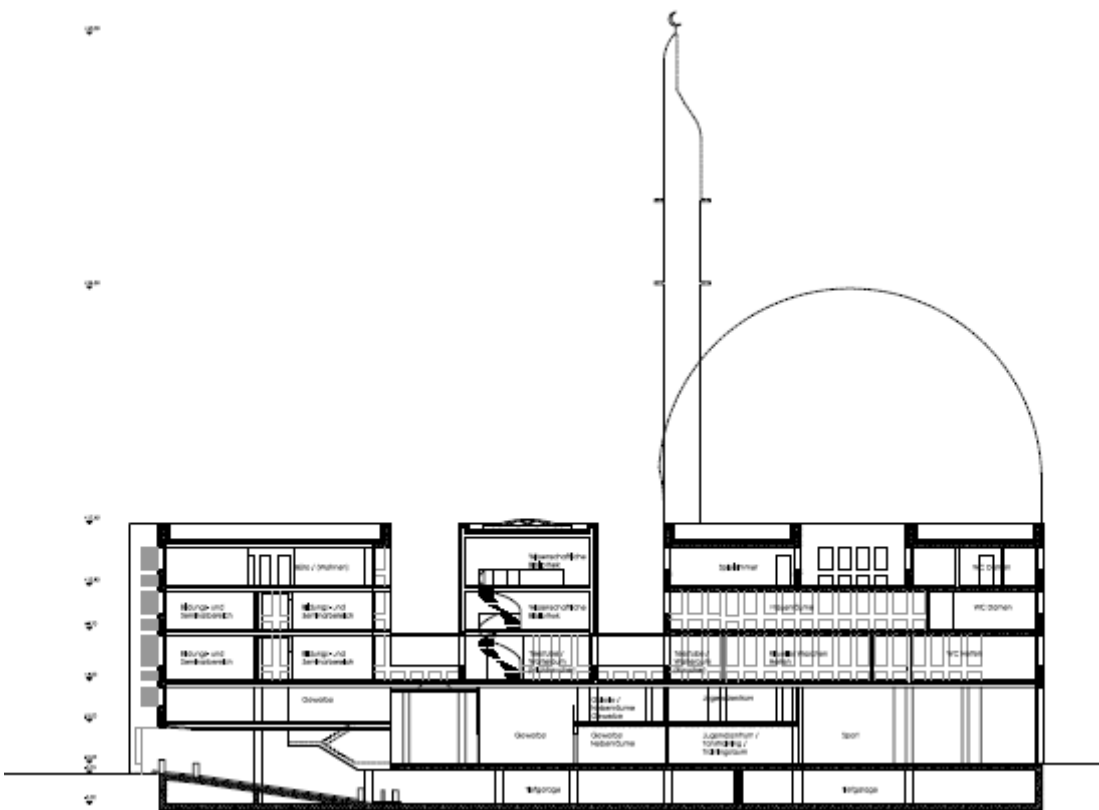

Schnitt Fuchsstraße / Innere Kanalstraße (Verwaltungstrakt)

